



FOOTMANS LOOPS ANCHOR KIT



A simple, affordable, universal way to add solid anchor points for webbing straps to motorcycles, snow bikes, snowmobiles, ATVs, UTVs and 4x4s.

468397



8 16205 02071 8

1

Decide which configuration works best for your gear setup.

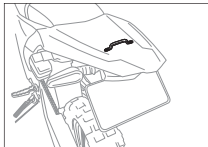

These are three of the most common examples of Footmans Loops installation locations.

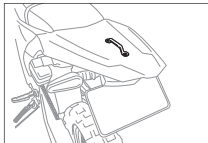

There is no right or wrong position to install the Footmans Loops, and your individual gear setup and motorcycle make/model will vary the locations. Position your gear in the ideal location, and mark anchor strap locations with a pencil.

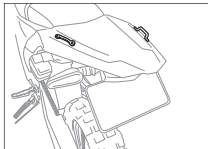

2 After locating the ideal Footmans Loops location, mark holes with a pen or pencil. Make sure hole locations are clear of wiring and other components on the underside of the fender.

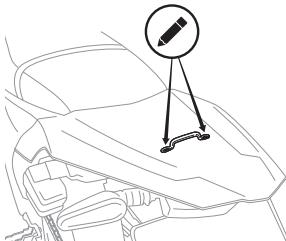

3 Drill holes through the fender in marked locations.

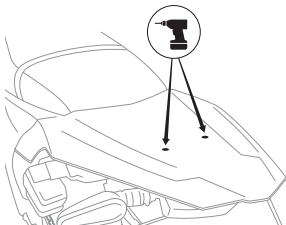

4 Using the included hardware, secure Footmans Loops with the round headed bolts on top. We recommend using thread lock to prevent bolts from vibrating loose.

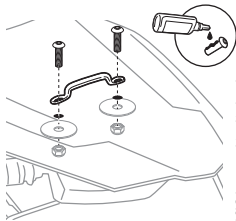

5 Add your gear using webbing. Pull snug and periodically check to ensure Footmans Loops and gear are secure.

